

LED TROFFER FIXTURE(New Construction)



Features

Input voltage:	AC100-277V
Operating frequency:	50/60Hz
Power factor:	> 0.95
Ambient temperature range:	-20°C ~+45°C
Color Temp:	3000K~5000K
THD:	≤10%
IP Rating:	IP40
CRI:	>Ra80
Beam angle:	120°

- Cloud series led troffer gives >125lm/W
- Support color temperature optional
- Support 3 power options
- Cloud series troffer can work with emergency power pack.
- 5 years' warranty.
- ETL DLC Premium

Parameter

Length	Product code	Certification	CRI	Wattage	Description Function	Lumens 3000/4000/5000K	Packing/carton	G.W./carton
2x2ft	ML-PN2*2-Q01-K40-3050	ETL/cETLus,DLC,	>80	20/30/40W	3-in-1 dimming(0-10V;PWM;Rx) CCT Tunable & Power adjustable	2500-5000 LM	650*180*650mm 2 pieces 1*40HQ Loading=1850pcs	7.5kg
2x4ft	ML-PN2*4-Q01-K60-3050	ETL/cETLus,DLC,	>80	40/50/60W	3-in-1 dimming(0-10V;PWM;Rx) CCT Tunable & Power adjustable	5000-7500 LM	1260*180*650mm 2 pieces 1*40HQ Loading=930pcs	13kg

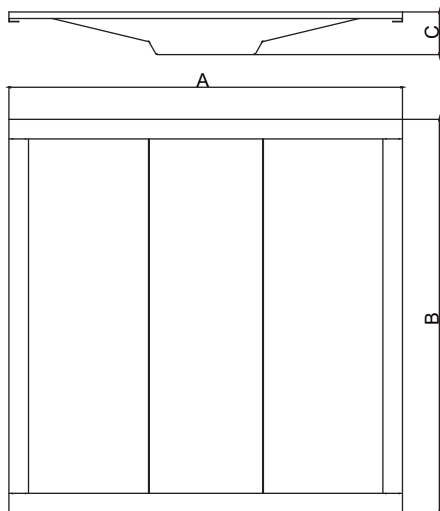

Maximum overall	A	B	C
2*2ft	603mm	603mm	70mm
2*4ft	603mm	1213mm	70mm

Wiring diagram

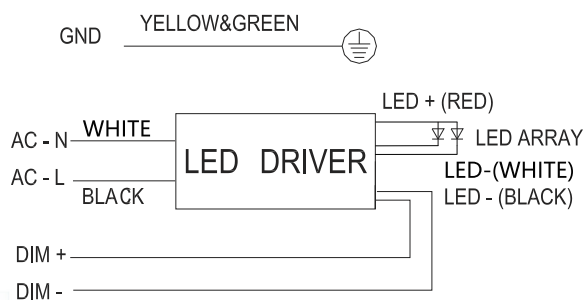
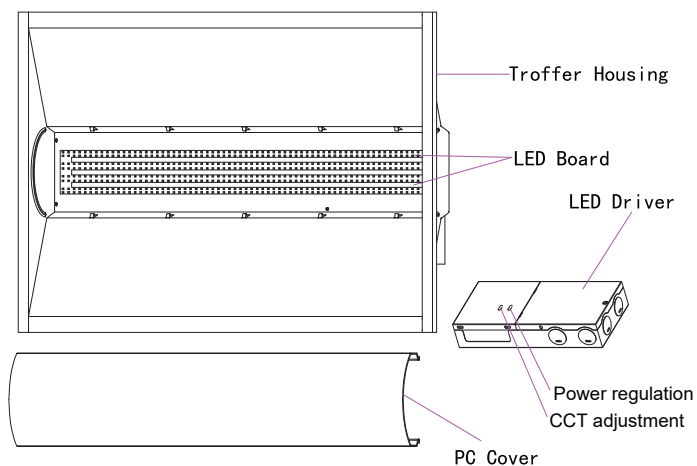

Electric Shock Attention

Ensure the power supply has been cut off before connecting the wire, and all wiring and installation of this product are required to be operated by professionals.

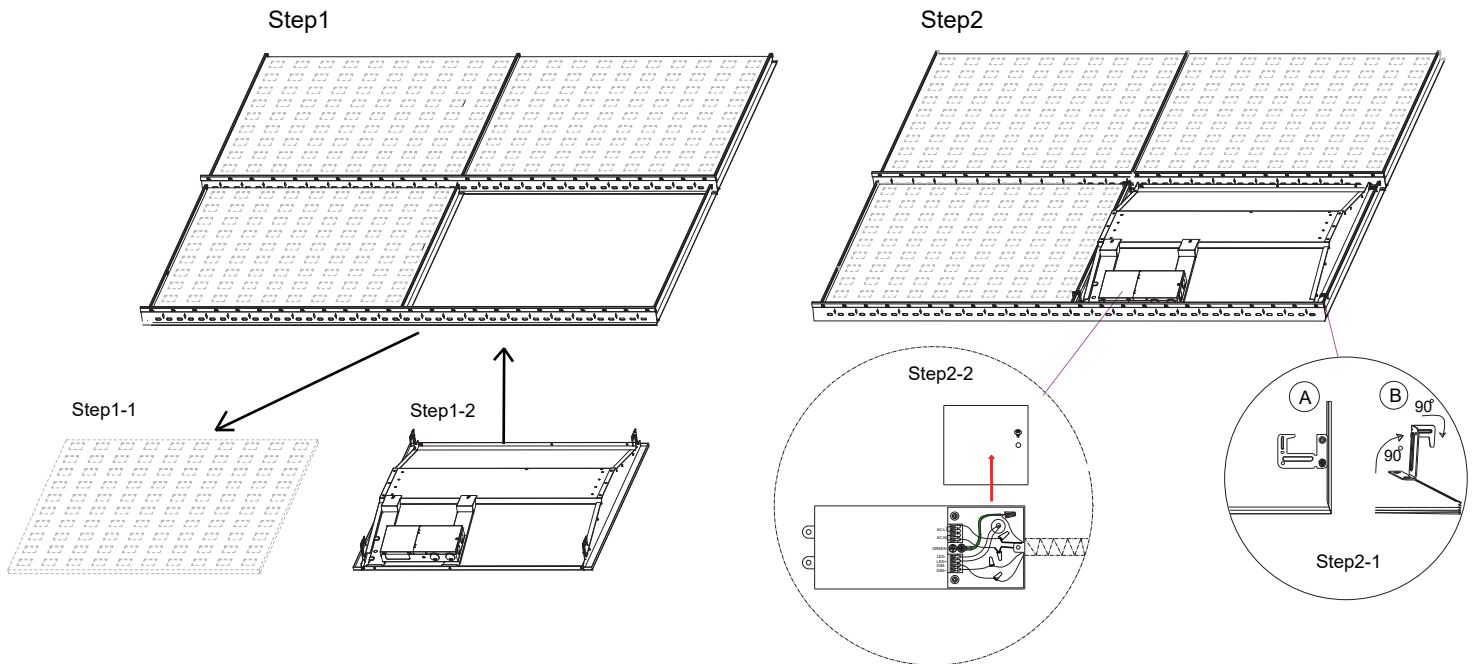

Step 1: Make sure of all the power is off before installing. Remove the one ceiling tile that you need to install light fixture on. Then place the light fixture on the T-bar carefully and make sure it is correctly in place and secure.

Step 2: Lift the 4 buckles on the back of the panel up by 90° then bend the top part of the buckles 90° towards the direction where you can anchor the light fixture to the T-bar.

Step 3: Open the driver's junction box and connect the AC wire to the driver correctly (L=black & N=white)

Warning:

Make sure all the power is off before installation.

All the installations are required to be done by professionals.